



6/44-46 Pratley Street Woy Woy NSW

3  1  1 

This bright and airy three-bedroom townhouse enjoys a convenient location with transport at the door and approx. 5 mins drive to Woy Woy CBD & train station and within a short stroll to the Golf Club & sports grounds.

The property itself offers a large open plan flowing living/dining area which flows through glass sliding doors onto your private courtyard, a large kitchen with breakfast bar and great size bedroom all with balcony access.

- Good size three-bedroom townhouse
- All bedrooms have sliding doors to balcony's
- Central location
- Private courtyard
- Single carport
- Spacious living dining area
- 5min drive to the Train station & CBD
- 5m walk to golf Club

Price : \$ 630,000
Building Size : 120 sqm
Land Size : 188 sqm
View : <https://www.wilsonsproperty.com.au/sale/nsw/central-coast-region/woy-woy/residential/townhouse/7966889>



Andrew Quilkey
02 4344 2511



Jessica Warren
02 4344 2511

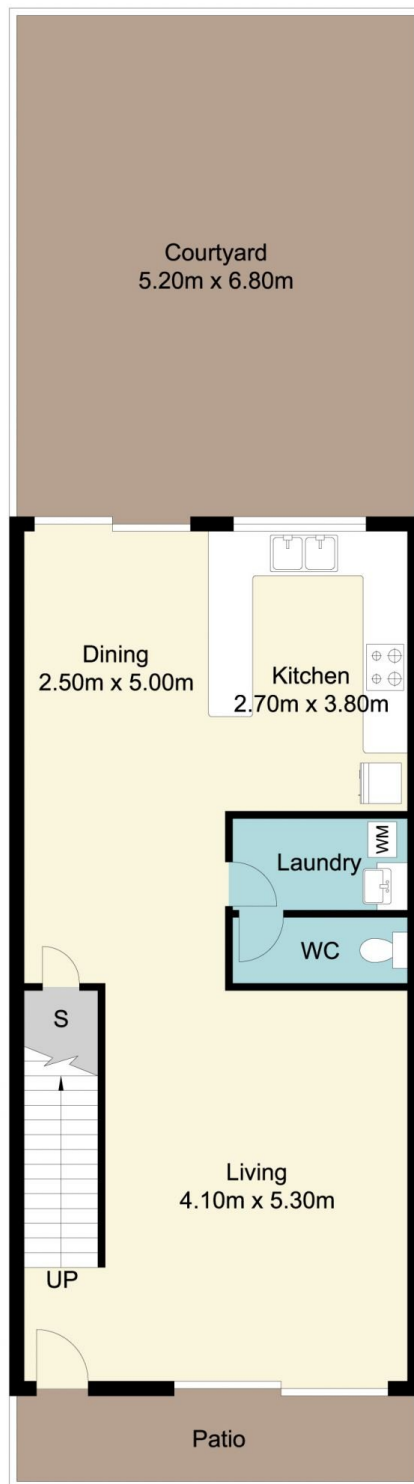

Ground Floor

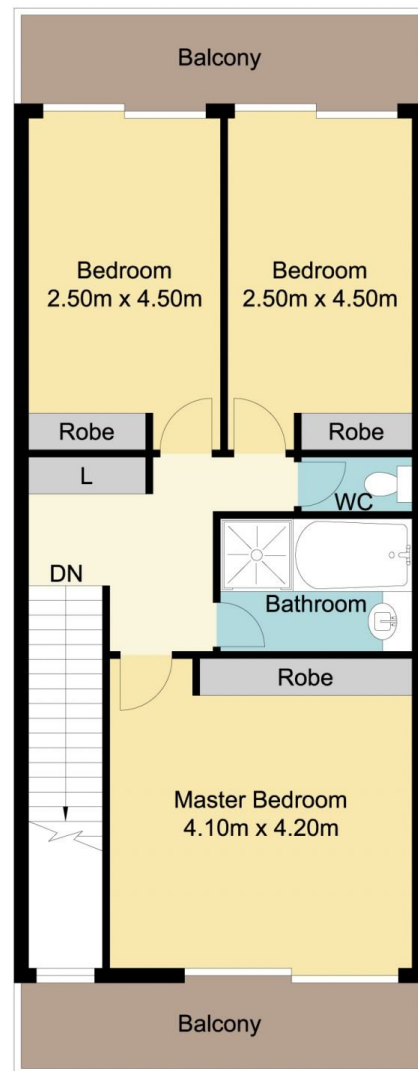
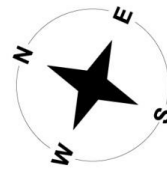

First Floor

6/44-46 Pratley Street, Woy Wo

Total Approx Floor Area 119.96 sq.m

Measurements are approximate. Not to scale. Illustrative purposes only. Boundaries are approximate.