



17 Mountain Ash Way Umina Beach NSW

4 🏠 3 🚗 2 🚗

This beautiful 4 bedroom home is located in the ever popular South Umina area and has just been offered to the rental market for the first time.

Property features include:

- Multiple living areas
- 4 good size bedrooms
- 3 updated bathrooms (ensuite to main)
- Large kitchen with ample amount of storage
- Double lock up garage
- Ducted air conditioning upstairs & split system downstairs
- Short walk to the beach
- Close to shops, cafes & popular restaurants.

Contact now to register your interest so you dont miss out.

Pets considred on application.

Land Size : 531 sqm
View : <https://www.wilsonsproperty.com.au/lease/nsw/central-coast-region/umina-beach/residential/house/7181294>



Loren Savage
0243442511



Kala Bennett
0423 560 135



17 Mountain Ash Way, Umina Beach

Total Approx. Floor Area 199.7 sq.m.

Measurements are approximate. Not to scale. For illustrative purposes only. Boundaries are approximate.

SITE PLAN

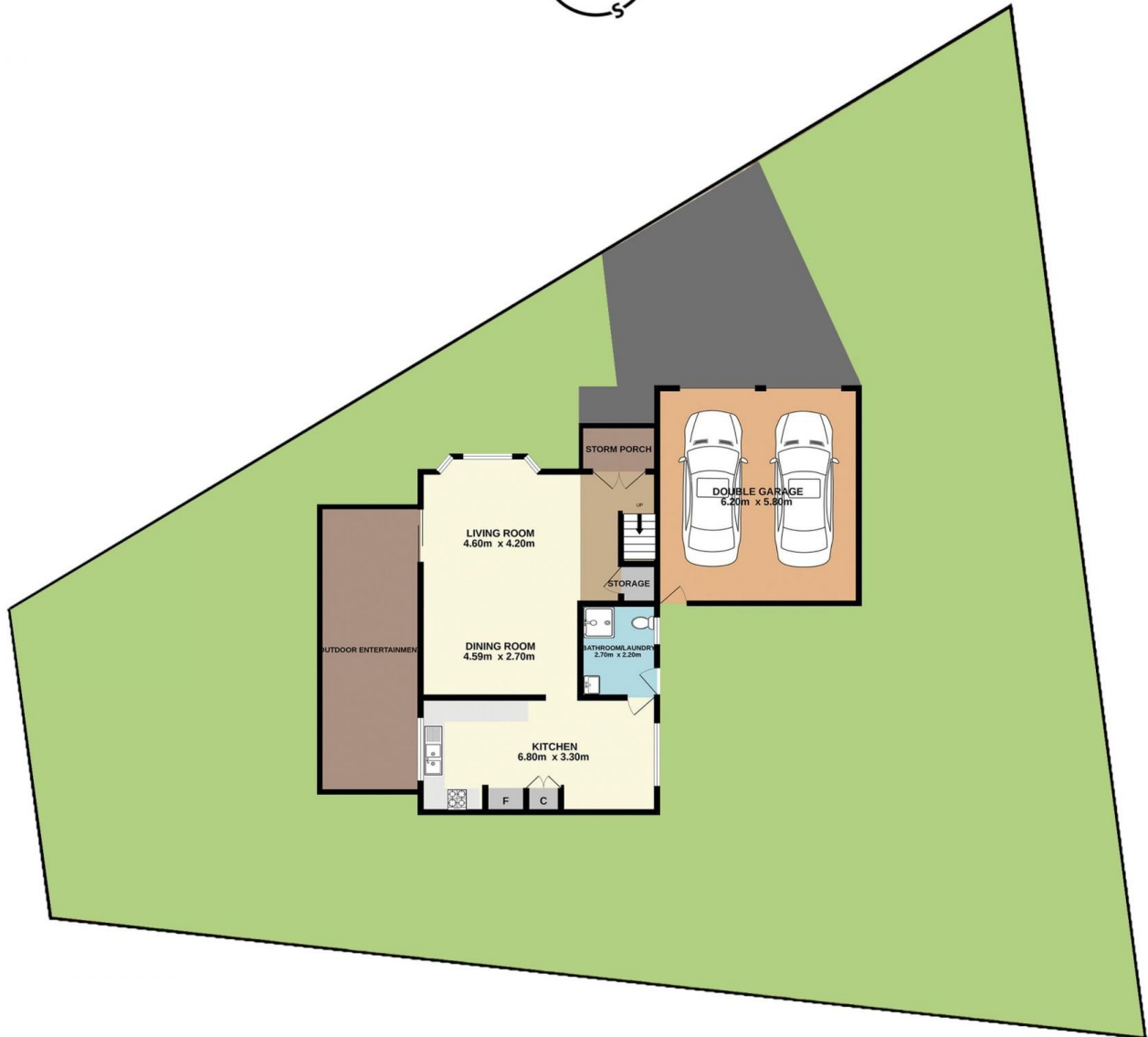

17 Mountain Ash Way, Umina Beach

Measurements are approximate. Not to scale. For illustrative purposes only. Boundaries are approximate.